

产品手册

Product Manual



DISTRIBUTED BY



บริษัท บุญเยี่ยมและสหาย จำกัด

BOONYIUM AND ASSOCIATES LIMITED
1314-1322 ถนนศรีนครินทร์ แขวงอ่อนนุช เขตสวนหลวง กรุงเทพฯ 10250
1314-1322 Srinakarin Road, On Nut, Suanluang, Bangkok 10250, THAILAND
Tel. 02-322-1878 (Auto Line), 02-322-4330-3 Fax: 02-322-4328-8
Burner Section : 02-322-9388-8 Fax: 02-322-9388-8
http://www.boonyium.com Email: burner@boonyium.com

让燃烧完美而简约
Make The Combustion Perfect And Simple



COMPANY INTRODUCTION 公司介绍

DYDTEC Group is specialized in combustion industry. Our products and services include industrial burner, combustion system, flame treatment system, air heater, heat exchanger, project renovation for combustion safety, energy saving and low nitrogen, maintenance of combustion system. We see us as a solution provider in the combustion industry and can satisfy the needs from customers.

Over 10 years expanding, DYDTEC has supplied thousand of combustion systems and air heaters. We have rich application experiences in various industries including automotive, environment protection, industrial drying, light industry and heavy industry.

Our product applies the European standard EN746 and American standard NFPA86.

DYDTEC entered overseas market in 2016, we have successfully exported our products to the areas including US, EU, Africa, Asia and Pacific.

With our motto of faith, DYDTEC is dedicated to be excellent, honest, diligent, responsible. We have become the industrial combustion market leader in China and we are ambitious to become an outstanding brand worldwide in the field of industrial combustion in the next decade.



DUCT BURNER

MAKE THE COMBUSTION PERFECT AND SIMPLE



LRSP-HC Burner

LRSP-HC series burner is a direct fired hot air heating high-power burner designed by DYDTEC according to the standard EN746-2. The LRSP-HC burner is installed in the air duct, which can generate a wide flame heating area in a short time. It can be applied to various medium and low temperature heating applications, such as hot air oven, industrial drying furnace and hot air furnace, especially for the working conditions with limited heating space.

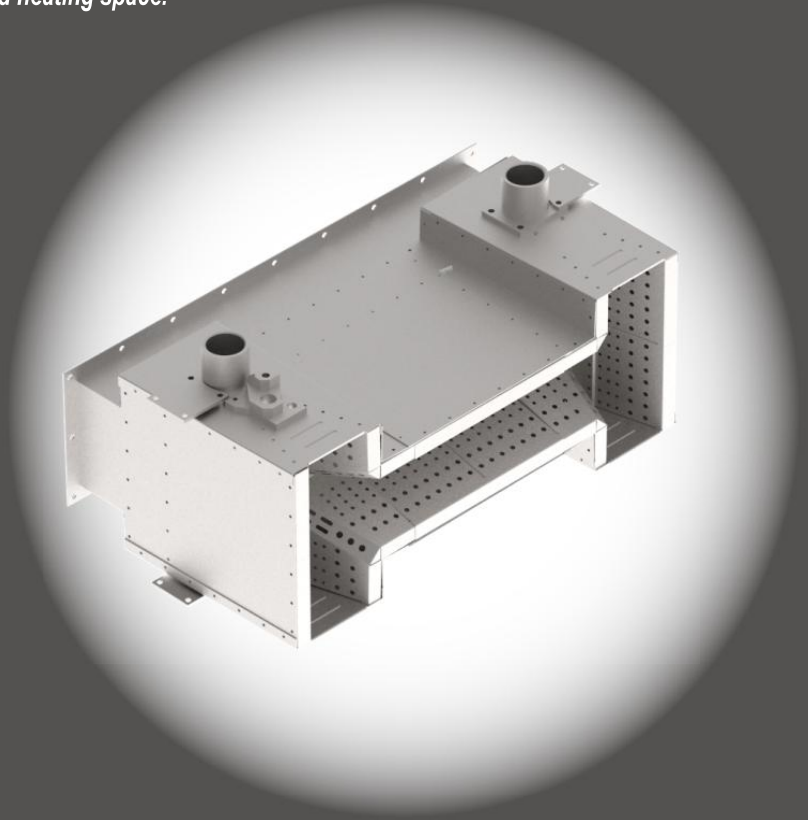

- *Various specifications, all metal components*
- *Capacity: 500kW~8000kW*
- *Stable and clean combustion, low NOx emission*
- *High precision regulation ratio of 40:1*
- *Faster and more accurate temperature regulation*
- *Applicable to natural gas and LPG*
- *Low gas pressure requirement*
- *Integrated design, simple installation*
- *Easy to operate and maintain*



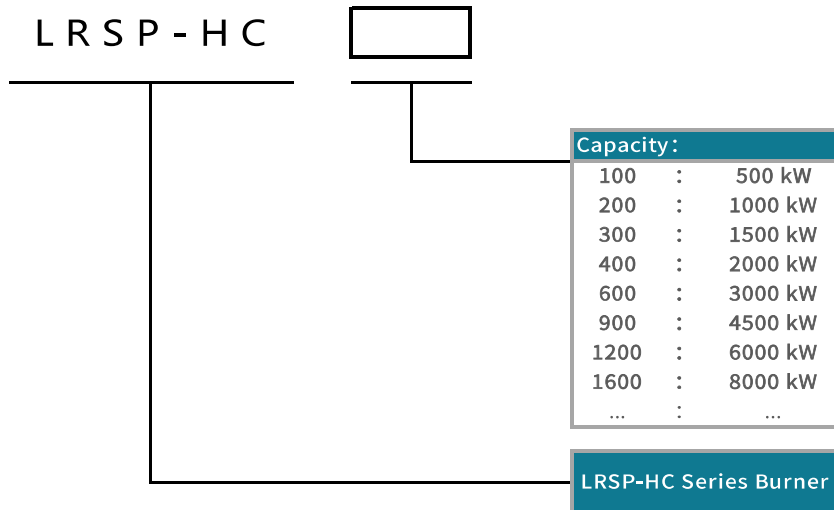

PARAMETERS

Basic Parameters

Item	Valve	Remarks
Series	LRSP-HC	
Rated capacity (kW)	500~ 8000	Please contact us for other capacity.
Regulation ratio	40:1	
Inlet pressure of pipeline valve (kPa)	20~30	
Oxygen content in combustion air	21%	Contact us when the burner is not used in standard condition.
Max. upstream temperature-cast aluminum (°C)	245	
Max. upstream temperature-cast iron (°C)	400	
Max. downstream temperature-cast aluminum (°C)	400	
Max. downstream temperature-cast iron (°C)	700	
Flame length (mm)	900	
Optimal air speed (m/s)	10 ~ 20	

02

Application 

LRSP-HC burner is applicable to various low-temperature heating applications, and the appropriate application mode can be selected according to the on-site working conditions.

SPLIT APPLICATION

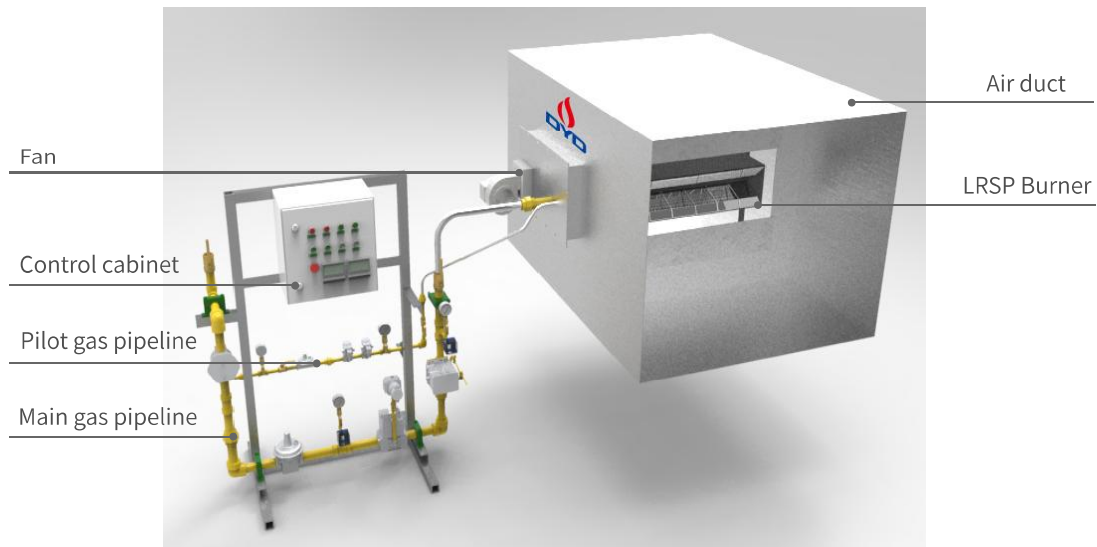

INTEGRATED APPLICATION

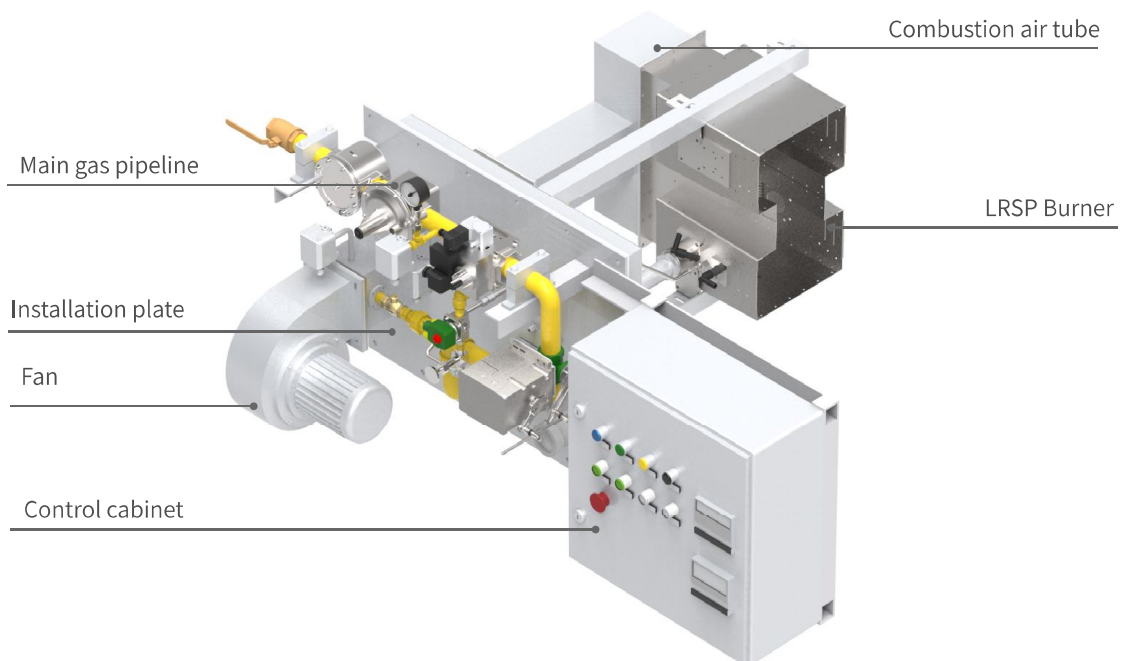

03

Data curve

Burner capacity and flame length

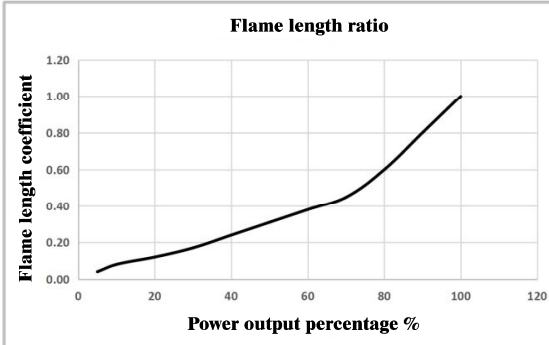

Relationship between air pressure drop, wind speed and flame length

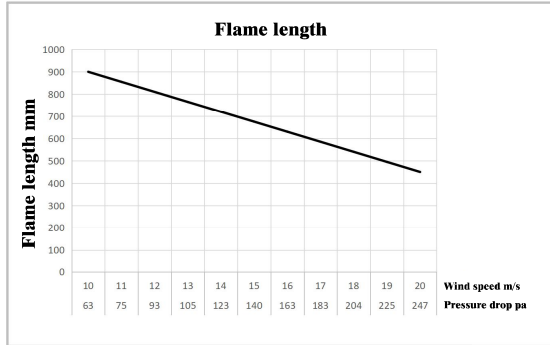

Burner capacity and CO emission (at 15% O₂/2mbar combustion air pressure)

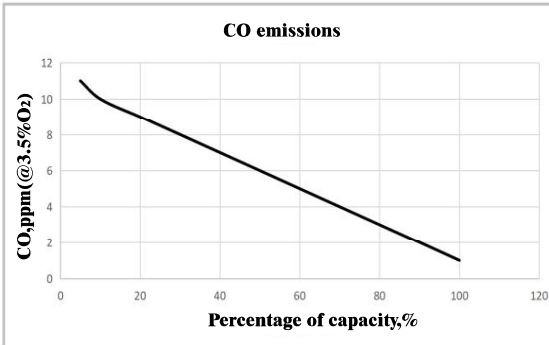

Burner capacity and NO_x emission (at 5% O₂/2mbar combustion air pressure)

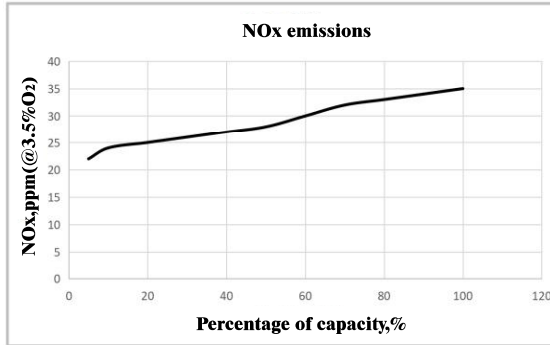

04

Overall

LRSP-HC-100

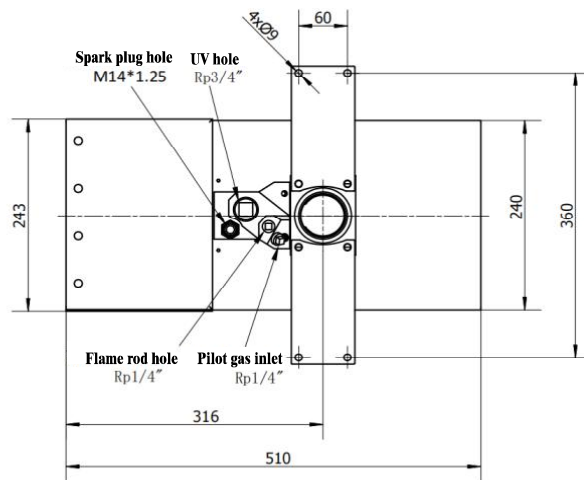
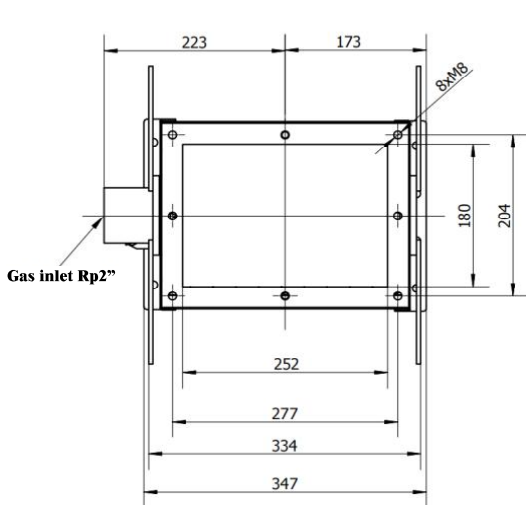

LRSP-HC 200

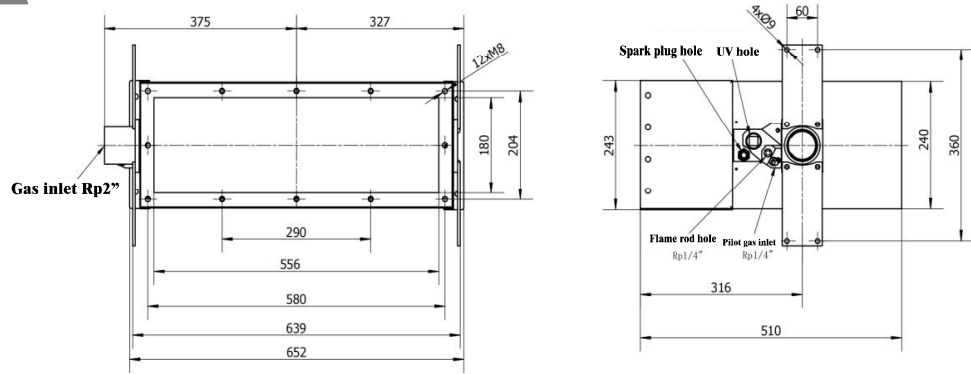

LRSP-HC 300

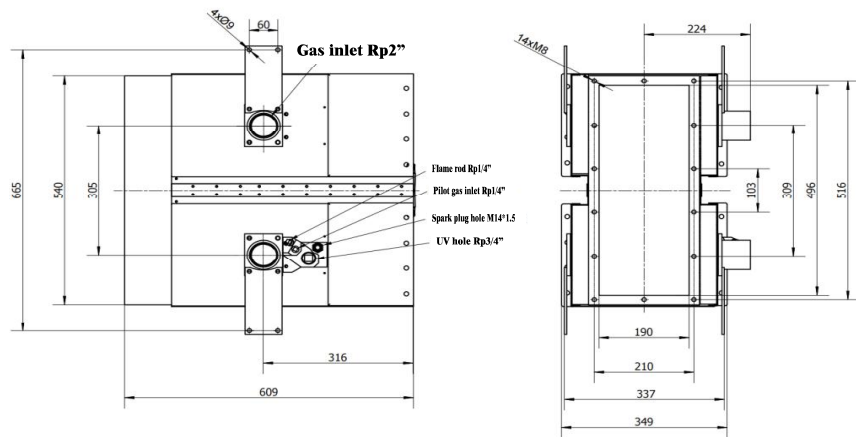

LRSP-HC 400

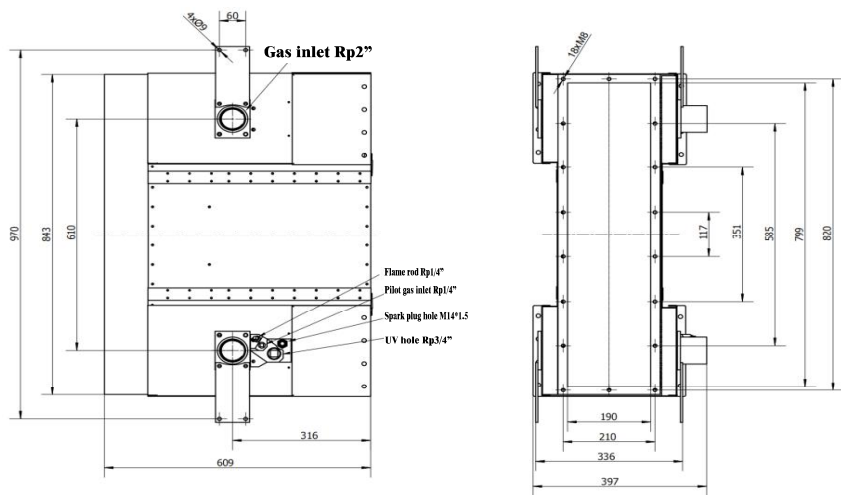

LRSP-HC 600

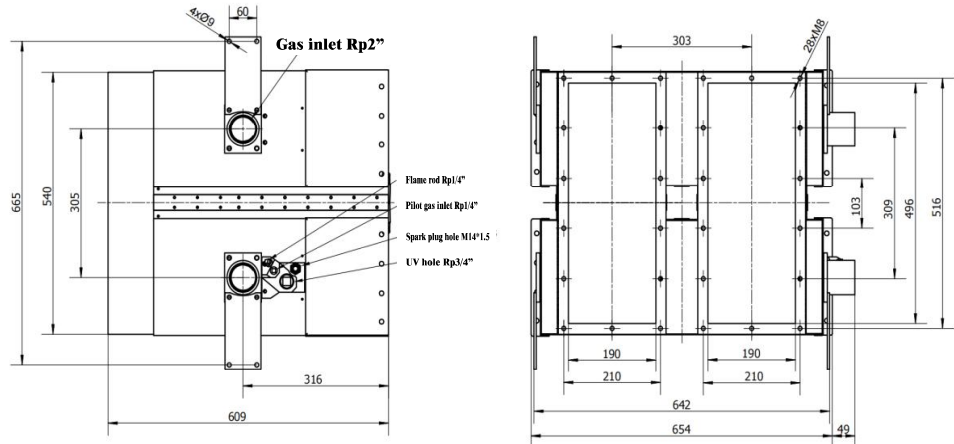

LRSP-HC 900

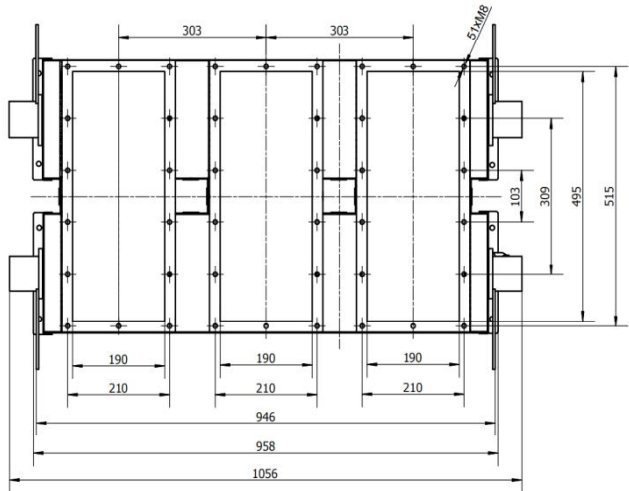
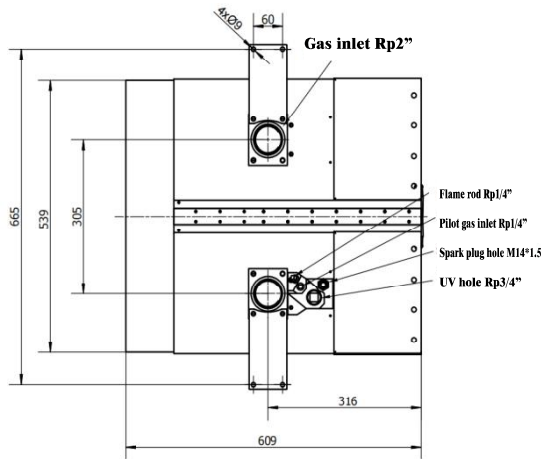

LRSP-HC 1200

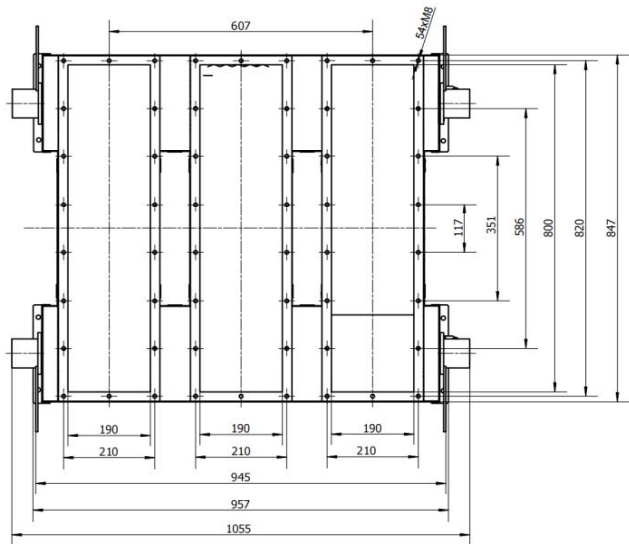
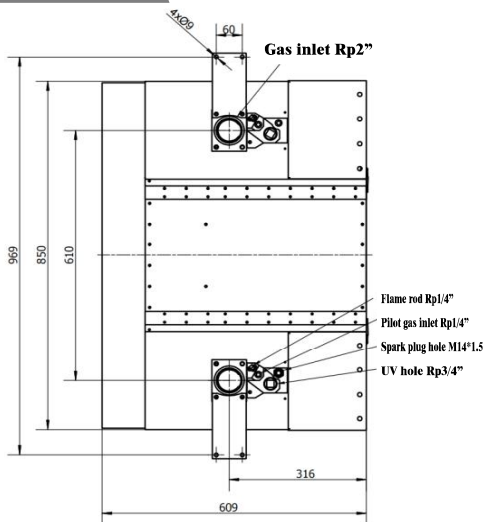

LRSP-HC 1600

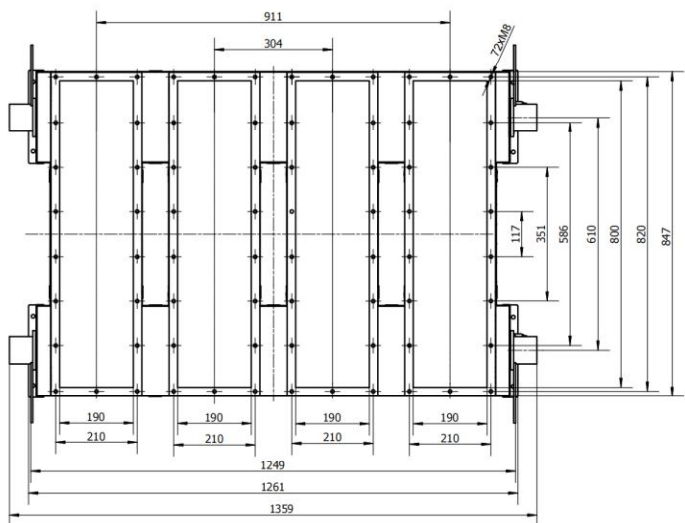
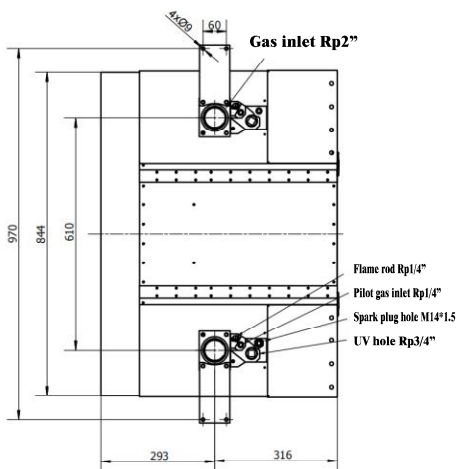

05

Installation

SCHEMATIC STRUCTURE

The installation of lrsp burner is flexible, and the burner body can be installed horizontally, vertically upwards or vertically downwards according to the needs of on-site working conditions.

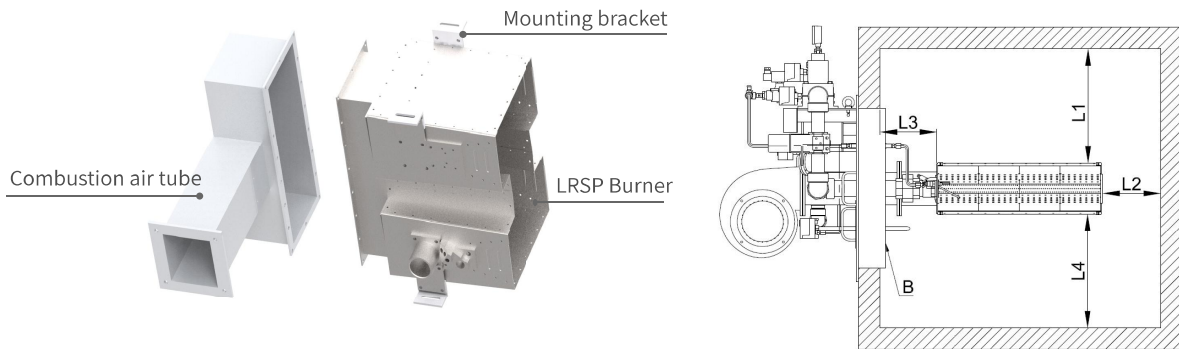

INSTALLATION NOTES



- The distance between the burner edge and the inner wall of the pipe in all directions shall not be less than 150mm;
- Place B shall be sealed with 304 stainless steel plate after filling with insulation cotton;
- When the furnace is ignited for the first time at the design temperature, please check the shrinkage of the fibers around the burner and refill the gap with fiber refractory to ensure the sealing between the inner and outer walls of the furnace.

06

Accessories

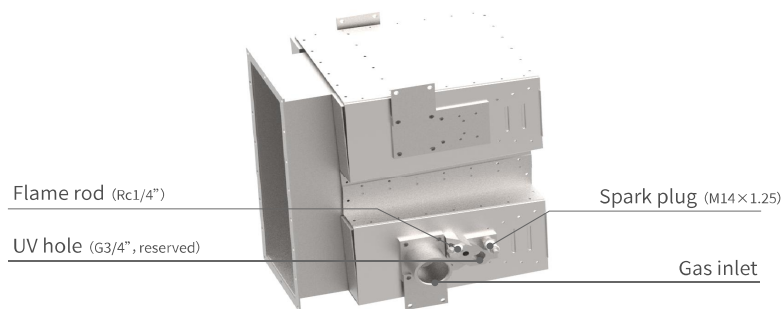
BURNER ACCESSORIES



NO.	Accessor	Type	Photo	Applicaton
1	Spark Plug	RP-SE-L		Suitable for all series, and the upstream temperature of burner is $\leq 100\text{ }^{\circ}\text{C}$
2	Flame Rod	RP-FE-1/4-150-5-42		Suitable for all series



DISTRIBUTED BY



บริษัท บุญเยี่ยมและสหาย จำกัด
BOONYIUM AND ASSOCIATES LIMITED
1314-1322 ถนนศรีนครินทร์ แขวงอ่อนนุช เขตสวนหลวง กรุงเทพฯ 10250
1314-1322 Srinakarin Road, On Nut, Suanluang, Bangkok 10250, THAILAND
Tel. 02 322 1878(Auto Line) 02 322 4330-3 Fax. 02 322 4328-8
Burner Section : 02 322 9385-8 Email:burner@boonyium.com
<http://www.boonyium.com>

DYDTEC COMBUSTION

Add: Floor 1&4 of Building 1, No.111 Zhiye Road Pudong District, China

Tel: 86-21-58814568

E-mail: info@dydtec.com

Web: www.dydtec.com

